

## **OFFICIAL NOTICE AND AGENDA**

The City of Stoughton will hold a **Regular** meeting of the **Landmarks Commission** on **Thursday, January 14, 2016, at 7:00 pm** in the **Hall of Fame Room, Lower Level, City Hall, 381 E. Main Street, Stoughton, WI.**

### **AGENDA:**

1. Call to order.
2. Consider approval of the Landmarks Commission meeting minutes of December 10, 2015.
3. Ben and Emily Thompson request a Certificate of Appropriateness to replace attic windows at 620 S. Prairie Street.
4. Status Update for 1892 High School.
5. Discuss Linderud Collection.
6. Commission Reports/Calendar.
7. Future agenda items.
8. Adjournment.

1/5/16mps

### **COMMISSIONERS:**

Peggy Veregin, Chair  
Alan Hedstrom, Vice-Chair  
Josh Mabie

Michael Engelberger (Council Rep)  
Greg Pigarelli, Secretary

Kimberly Cook  
Stephen Mar-Pohl

### **EMAIL NOTICES:**

Art Wendt  
Council Members  
DErickson@madison.com  
thompsonben@gmail.com

Kelli Krcma  
Matt Dregne, City Attorney  
Receptionists  
Steve Kittelson

Stoughton Hub  
Leadership Team  
smonette@stolib.org

**Note: For security reasons, the front door of City Hall will be locked after 4:30 P.M. (including the elevator door). Please use the east employee entrance.**

**IF YOU ARE DISABLED AND NEED ASSISTANCE, PLEASE CALL 873-6677 PRIOR TO THE MEETING.**

**NOTE: AN EXPANDED MEETING MAY CONSTITUTE A QUORUM OF THE COUNCIL.**

## **Landmarks Commission Meeting Minutes**

**Monday, December 10, 2015 – 7:00 p.m.**

**City Hall, Hall of Fame Room, Lower Level, 381 E. Main Street, Stoughton, WI.**

**Members Present:** Peggy Veregin, Chair; Alan Hedstrom, Vice-Chair; Josh Mabie; Kimberly Cook; Stephen Mar-Pohl and Michael Engelberger

**Absent:** Greg Pigarelli

**Staff:** Zoning Administrator, Michael Stacey

**Guests:** Amy Kallas; Roger Springman; Tim Swadley and Katherine Foster

1. **Call to order.** Peggy called the meeting to order at 7:00 pm.
2. **Consider approval of the Landmarks Commission meeting minutes of November 12, 2015.**  
Motion by **Michael E** to approve the minutes as presented, 2<sup>nd</sup> by **Alan**. Motion carried 5 – 0.
3. **Present 2015 Historic Preservation Award to John and Amy Kallas.**  
Peggy presented Amy Kallas with the 2015 Historic Preservation Award. Josh arrived at 7:02
4. **Status Update for 1892 High School.**  
Peggy stated the CLG grant application has been submitted and explained the process for submittal. The grant would cover the cost of a feasibility study. Kimberly stated there are typically 8 – 10 awards given out which should be known by March.

Other potential options for the funding of a feasibility study include City contingency funds or a grant from the Bryant Foundation.

Stephen is working on a scenario that would move the building approximately 200 feet to the northeast corner of North Street and Forrest Street. Peggy is checking with the National Parks Service to find out if the building could still maintain its historic status in the new proposed location.

Roger Springman and Katherine Foster of Sustainable Stoughton spoke in support of efforts to find a viable use of the building and provided ideas to combine efforts with the Landmarks Commission and School District to come up with meaningful questions for the proposed community survey. There was a lengthy discussion about how to proceed while being a supporter of the school.

Questions are currently being formulated by a consulting firm for the school district.

Peggy plans to contact School Board President Liz Menzer to discuss assisting with the survey questions.

5. **Commission Reports/Calendar.**  
Peggy discussed files she had found related to the Linderud Collection of photos. The photo collection was provided by the Linderud family for the discretion of the Stoughton Historical Society.

6. **Future agenda items.** None discussed.
7. **Adjournment.** Motion by Alan to adjourn at 9:15 pm, 2<sup>nd</sup> by Josh. Motion carried 6 – 0.

Respectfully Submitted,

*Michael Stacey*

# City of Stoughton Certificate of Appropriateness

## Application Form

1. Name of Property: Jennie B and John A. Martin House

Address of Property: 620 S. Prairie St.

Name of historic district in which property is located: Southwest

### 2. Owner & Applicant Information

Owner Name: Ben & Emily Thompson

Street Address: 620 S. Prairie St.

City: Stoughton State: WI Zip: 53589

Daytime Phone, including Area Code: 608-886-0382 thompsoeben@gmail.com

Applicant (if different from owner): \_\_\_\_\_

Applicant's Daytime Phone, including Area Code: \_\_\_\_\_

### 3. Attachments. The following information is enclosed:

- ☒ Photographs
- ☐ Sketches, elevation drawings
- ☐ Plan drawings
- ☐ Site plan showing relative location of adjoining buildings, if located within a Historic
- ☐ Specifications
- ☐ Other (describe)

### 4. Description of Proposed Project (on next page)

### 5. Signature of Applicant

Signed: Benjamin P. Thompson Date: 12/22/15

Printed: \_\_\_\_\_

**Return To:** Zoning Administrator, Stoughton City Hall, 381 E. Main Street

## Description of Proposed Project

(attach additional sheets as necessary)

Architectural Feature: Attic windows.

Approximate date of feature: ? Frames ~ 1904, storm windows much later

Describe existing feature: Currently only frames with deteriorated metal storm windows.

Describe proposed work, materials to be used and impact to existing feature:

New window units will be installed for windows shown in attached photographs

Photograph No. \_\_\_\_\_ Drawing No. \_\_\_\_\_

Architectural Feature: \_\_\_\_\_

Approximate date of feature: \_\_\_\_\_

Describe existing feature: \_\_\_\_\_

Describe proposed work, materials to be used and impact to existing feature:

Photograph No. \_\_\_\_\_ Drawing No. \_\_\_\_\_



North Window



North Window





Top

North Window Interior (Left side)



Top

North Window Interior (Right side)



South Window



South Window





Top

South Window Interior



Top

South Window Interior



South window interior close-up



## Window and Door Details

Line Number	001-1	Jamb Depth	5 1/2"
Label	None Assigned	Jambs Applied	Yes
Product Name	Heritage Rectangle Double Hung (WDH)	Jambs Exact	No
Configured in PK Version	377	Installation Clips	None

Scaled To Fit

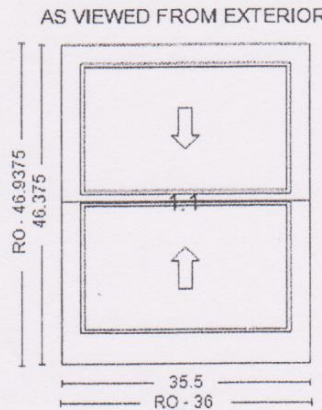

Quantity  
Cubic Feet  
Unit Price  
Extended Price

## \*\*\* Pricing Details \*\*\*

Base Price  
Non-Standard Screen Size  
Screen  
Non-Standard Size  
Lower Glass Preserve  
Upper Glass Preserve  
Extension Jamb

## \*\*\* Overall Dimensions \*\*\*

Overall Frame Width	35 1/2"
Overall Frame Height	46 3/8"
Overall Rough Opening Width	36"
Overall Rough Opening Height	46 15/16"
Overall Unit Dimension Width	37 7/8" X
Overall Unit Dimension Height	48 1/16" X

## \*\*\* Dimensions \*\*\*

Call Width	30
Call Height	Custom
Individual Frame Width	35 1/2"
Individual Frame Height	46 3/8"
Glass Width	30"
Glass Height	18 31/32"

## \*\*\* Casing-Jambs-Trim \*\*\*

Exterior Casing/Accessories	Standard Brickmould
Back Bevel	No
Sill Nosing	Standard Sill Nosing
Extended Horns	No
Apply Exterior Casing/Accessories	Yes

Performance \*\*\* Performance \*\*\* Standard Performance

Unit Type \*\*\* Unit \*\*\* Complete Unit  
Production Current  
Model Traditional  
Clad Profile No  
Sash Material Wood

Glass \*\*\* Glass \*\*\* H-K LoE 270 Insulated  
Glass Spacer Mill Finish  
High Altitude No  
Glass Preserve / Neat Coating Glass Preserve without Neat Coating

Glazing Bead Beveled  
Upper Glass - Glass Type Clear  
Upper Glass - Obscure / Opaque Glass None  
Upper Glass NOT Tempered  
Lower Glass - Glass Type Clear  
Lower Glass - Obscure / Opaque Glass None  
Lower Glass NOT Tempered

## \*\*\* Hardware-Accessories \*\*\*

Hardware Color Clay (Rustic)  
Sash Plough Both Sash Plough  
Sash Limit Clips None  
Screen Full Screen  
Mesh Type BetterVue Fiberglass  
Screen(s) Applied No  
Jambliner Beige

## \*\*\* Species-Finish-Color \*\*\*

Change Species Leave All Pine  
Exterior Frame Finish Primed Latex  
Exterior Sash Finish Primed Latex  
Interior Frame Finish Unfinished  
Interior Sash Finish Unfinished  
Screen Color White  
Fingerjoints Standard Fingerjoints



Printed By: Roger Midthun  
Created: 12/16/2015

This report does not include Non-Kolbe Items

- THANKS - KEVIN

2015 Pricing

Window and Door Details Page 1 of 2



## Window and Door Details

Line Number	001-1	Jamb Depth	5 1/2"
Label	None Assigned	Jambs Applied	Yes
Product Name	Heritage Rectangle Double Hung (WDH)	Jambs Exact	No
Configured in PK Version	377	Installation Clips	None

AS VIEWED FROM EXTERIOR

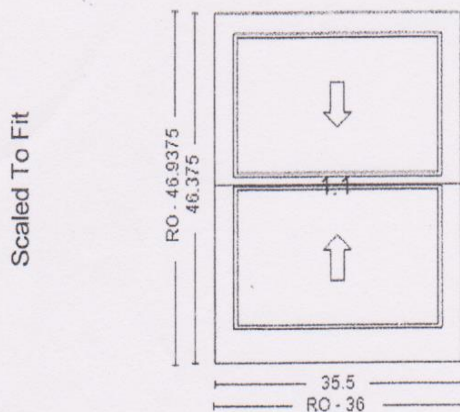

Quantity  
Cubic Feet  
Unit Price  
Extended Price

## \*\*\* Pricing Details \*\*\*

Base Price  
Non-Standard Screen Size  
Screen  
Non-Standard Size  
Lower Glass Preserve  
Upper Glass Preserve  
Extension Jamb

## \*\*\* Overall Dimensions \*\*\*

Overall Frame Width	35 1/2"
Overall Frame Height	46 3/8"
Overall Rough Opening Width	36"
Overall Rough Opening Height	46 15/16"
Overall Unit Dimension Width	37 7/8" X
Overall Unit Dimension Height	48 1/16" X

## \*\*\* Dimensions \*\*\*

Call Width	30
Call Height	Custom
Individual Frame Width	35 1/2"
Individual Frame Height	46 3/8"
Glass Width	30"
Glass Height	18 31/32"

## \*\*\* Casing-Jambs-Trim \*\*\*

Exterior Casing/Accessories	Standard Brickmould
Back Bevel	No
Sill Nosing	Standard Sill Nosing
Extended Horns	No
Apply Exterior Casing/Accessories	Yes

Performance Standard Performance

## \*\*\* Unit \*\*\*

Unit Type	Complete Unit
Production	Current
Model	Traditional
Clad Profile	No
Sash Material	Wood

## \*\*\* Glass \*\*\*

Glass	H-K LoE 270 Insulated
Glass Spacer	Mill Finish
High Altitude	No
Glass Preserve / Neat Coating	Glass Preserve without Neat Coating
Glazing Bead	Beveled
Upper Glass - Glass Type	Clear
Upper Glass - Obscure / Opaque Glass	None
Upper Glass	NOT Tempered
Lower Glass - Glass Type	Clear
Lower Glass - Obscure / Opaque Glass	None
Lower Glass	NOT Tempered

## \*\*\* Hardware-Accessories \*\*\*

Hardware Color	Clay (Rustic)
Sash Plough	Both Sash Plough
Sash Limit Clips	None
Screen	Full Screen
Mesh Type	BetterVue Fiberglass
Screen(s) Applied	No
Jambliner	Beige

## \*\*\* Species-Finish-Color \*\*\*

Change Species	Leave All Pine
Exterior Frame Finish	Primed Latex
Exterior Sash Finish	Primed Latex
Interior Frame Finish	Unfinished
Interior Sash Finish	Unfinished
Screen Color	White
Fingerjoints	Standard Fingerjoints



Printed By: Roger Midthun  
Created: 12/16/2015

This report does not include Non-Kolbe Items

- THANKS - KEVIN

2015 Pricing

Window and Door Details Page 1 of 2