



## OFFICIAL NOTICE AND AGENDA

Notice is hereby given that the River and Trails Task Force Committee of the City of Stoughton, Wisconsin will hold a regular or special meeting as indicated on the date, time and location given below.

Meeting of the:

Date /Time:

Location:

Members:

### **RIVER AND TRAILS TASK FORCE COMMITTEE OF THE CITY OF STOUGHTON**

**Monday, March 7, 2016 @ 5:30 PM**

**Hall of Fame Room (381 E Main St, Stoughton WI 53589)**

Jon Lewis, Jim Wilcox, Sandra Black, Nancy Hagen, Bob Diebel, Joni Dean, Larry Liebmman, Ralph Erickson, Phil Caravello, David Sharpe, Councilperson Regina Hirsch, Parks and Recreation Director Tom Lynch

CC:

Attorney Matt Dregne, Donna Olson, Leadership Team, Stoughton Newspapers, Sarah Monette, Judi Krebs, Council Members.  
dDDialoregonobserver@wcinet.com. derickson@madison.com

\* Note-For security reasons, the front doors of the City Hall building (including the elevator door) will be locked after 4:30 p.m. If you need to enter City Hall after that time, please use the entrance on the east side of City Hall (the planning department door). If you are physically challenged and are in need of the elevator or other assistance, please call 873-6677 prior to 4:30 p.m.

#### **Item # CALL TO ORDER**

- |   |                         |
|---|-------------------------|
| 1 | Call to Order           |
| 2 | January 4, 2015 Minutes |
| 3 | Communications          |

#### **Item # OLD BUSINESS**

- |   |   |
|---|---|
| 4 | Division St. Park Riverbank Restoration Review (Aaron Steber) |
| 5 | Amundson Trail Update   |
| 6 | Kettle Park West Trails                                       |
| 7 | Helen Johnson Trail Dedication Time                           |

#### **Item # NEW BUSINESS**

- |   |                        |
|---|------------------------|
| 8 | Conservation Wish List |
| 9 | Future Agenda Items    |

#### **ADJOURNMENT**

River and Trails Task Force Committee Minutes  
Monday, January 4, 2016 5:30 pm  
Hall of Fame Room

Present: Jon Lewis, Jim Wilcox, Sandra Black, Bob Diebel, Joni Dean, Larry Liebmann, Ralph Erickson, David Sharpe, Tom Lynch.

Call to Order

1. Call to Order at 5:29 pm.
2. November 2, 2015 Minutes. Motion by Larry with a second by Ralph to approve. Carried.
3. Communications: Larry reported that the dirt piles next to the service road near the dam are gone. Larry suggested that this road be designated as a trail. Tom will check with the mayor to get the service road line painted.

Old Business

4. Division Street Park Riverbank Restoration Update: Tom reported that the contract has been signed. Tom asked for an update which should be in a few weeks and then he will report to our committee for review. A contractor will then be found.
5. Amundson Trail Update: Tom reported there has not been a Parks and Recreation Meeting in the last two months to approve the trail from Amundson to the hospital which will be black-topped. Discussed a section behind Bjoin Park which could benefit from blacktop. Discussed easements for the homes from the hospital to Cooper's Causeway. Decided to speak to Darren Marsh about ways to approach residents should easements be needed. The county has grant money for easements.
6. Helen Johnson Trail Update: The sign marking the trail has been ordered and a map was shared of where the sign will be placed. This will occur during the Spring Clean-Up Day on April 23, 2016 at 9:00 am.
7. Cherry Trees in Amundson Park: Tom reported that Dean Tangaman said the cherry trees are of no value. If there are other contacts who are interested in the tree, let Tom know.
8. Plantings along the river in Mandt Park: This will be a good project for Sustainable Stoughton or Scouts. Topic to be discussed at future meetings.

New Business.

9. Kettle Park West trails: Tom shared a plan of Kettle Park. The amount of acreage calls for 18 acres of park land but they are giving 10 acres and will pay Parks and Recreation for the other 8 acres. Trails were marked on the map but there is no marked trail going across Jackson Street. Tom will update the Task Force about the plan at each meeting.
10. Future Agenda Items: No items were discussed.

Adjournment: Motion by Jim with a second by Larry to adjourn at 6:30 pm.  
Respectfully submitted, Joni Dean.



# Yahara River STREAM STABILIZATION PROJECT

CITY OF STOUGHTON

FEBRUARY 2016

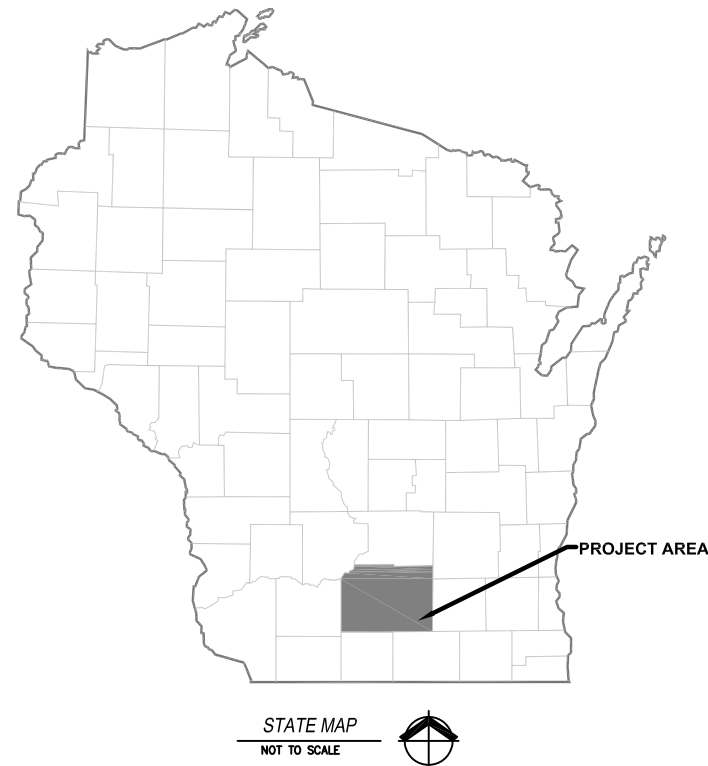

STATE MAP  
NOT TO SCALE

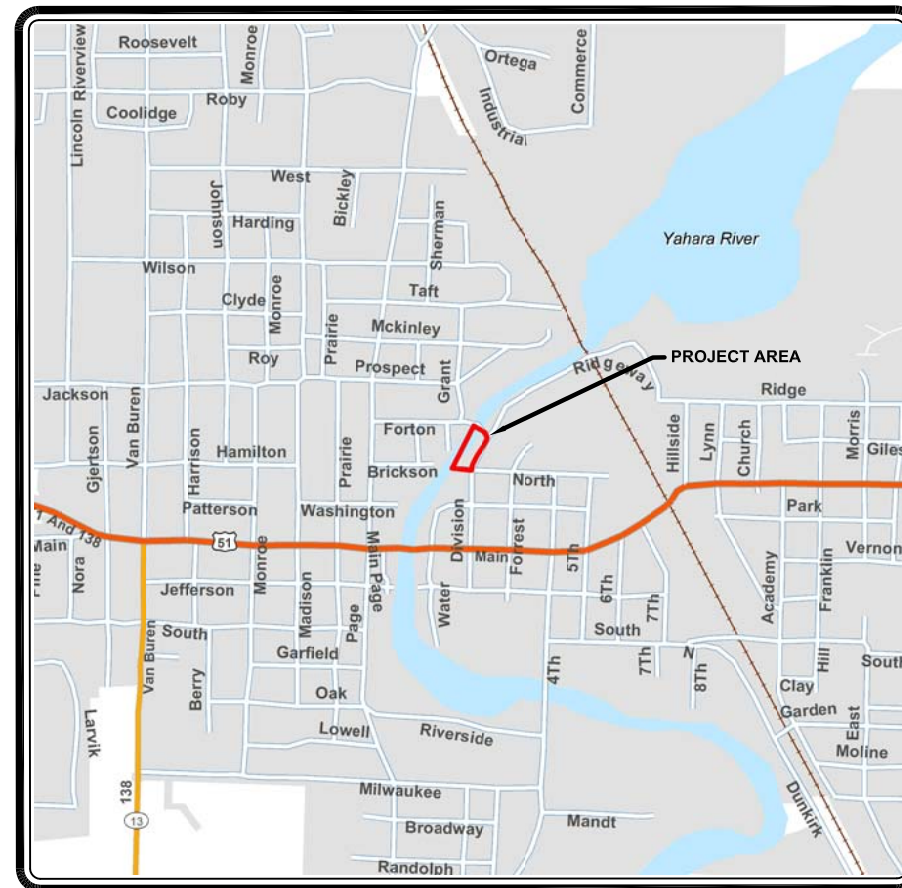

VICINITY MAP  
NOT TO SCALE



Toll Free (800) 242-8511  
Milwaukee Area (414) 259-1181  
Hearing Impaired TDD (800) 542-2289  
[www.DiggersHotline.com](http://www.DiggersHotline.com)



SITE MAP  
NOT TO SCALE



## SHEET INDEX

Sheet Number	Description
1	Project Location and Sheet Index
2	Existing Conditions
3	Proposed Conditions
4	Details
5	Erosion Control / Planting Plan









1. Work shall be completed at periods of low flow.
2. All equipment working in and around the stream channel shall be free of fluid leaks.
3. Care shall be taken to minimize equipment access to stream channel and riparian areas to prevent unnecessary damage or impacts.
4. All materials shall be inspected prior to installation and free of any damage or defects.
5. Stream bank areas shall be stabilized immediately following rootwad installation. Slope areas shall be installed after stabilization of the streambank.
6. Clear vegetation and grade existing steep upper edges of slope to a minimum 2:1 slope or flatter.
7. Seed slope area using Slope Stabilization Seed Mix specified.
8. Install NAG C-125BN or equivalent (coir based, long-term) in all sandy areas requiring erosion control blanketing.





Erosion and Sediment Control Notes:

Erosion control measures shown on these plans shall be initiated to prevent the transport of sediment from construction activities. If field inspections show these measures are unable to confine sediment to the project site, appropriate modifications will be made. All provisions of local and/or state erosion and sediment control regulations shall apply to this project.

- Sufficient oil and grease absorbing materials and flotation booms shall be maintained on site or readily available to contain and clean-up fuel or chemical spills and leaks.
- Dust on the site shall be controlled. The use of motor oils and other petroleum based or toxic liquids for dust suppression operation is prohibited.
- Rubbish, trash, garbage, litter, or other such materials shall be deposited into sealed containers. Materials shall be prevented from leaving the premises through the action of wind or stormwater discharge ditches or waters of the state.
- All points of construction ingress and egress shall be protected by a temporary construction entrance to prevent tracking of mud onto public right-of-ways. Where sediment is transported onto a public road surface, the road shall be thoroughly cleaned at the end of each day.
- Periodic inspections of the erosion control measures shall be made to assess their conditions. Any necessary repairs or cleanup to maintain the effectiveness of the erosion control devices shall be made immediately.
- Sediment control measures may require minor field adjustments at time of construction to ensure their intended purpose is accomplished.
- Surface flows over cut and fill slopes shall be controlled by re-directing flows from flowing over the exposed slopes without causing erosion.
- For any soil stockpiles, silt fence must be provided around the perimeter if the stockpile is located outside the perimeter erosion control for the site.
- Permanent or temporary soil stabilization must be applied to all exposed areas within 5 days after final grade is completed. Soil stabilization must also be applied to denuded areas which may not be at final grade but will remain dormant (undisturbed) for longer than 7 days. Soil stabilization measures include vegetative establishment and mulching.
- Temporary erosion control measures are not to be removed until all disturbed areas are stabilized. After stabilization is complete, all measures shall be removed within 30 days. Trapped sediment shall be spread and seeded.

FLOODPLAIN BENCH SEED MIX		
Botanical Name	Common Name	PLS Ounces/Acre
<b>Permanent Grasses:</b>		
<i>Andropogon gerardii</i>	Big Bluestem	15.00
<i>Asclepias incarnata</i>	Swamp Milkweed	2.00
<i>Aster ericoides</i>	Heath Aster	0.25
<i>Aster novae-angliae</i>	New England Aster	0.50
<i>Avena sativa</i>	Common Oat	360.00
<i>Calamagrostis canadensis</i>	Blue Joint Grass	0.50
<i>Carex stricta</i>	Common Tussock Sedge	0.50
<i>Elymus canadensis</i>	Canada Wild Rye	12.00
<i>Glyceria striata</i>	Fowl Mann Grass	1.00
<i>Iris Virginica</i>	Blue Flag	3.00
<i>Leersia conyzoides</i>	Rice Cut Grass	1.00
<i>Liatris pycnostachya</i>	Prairie Blazing Star	0.50
<i>Lolium multiflorum</i>	Annual Rye Grass	100.00
<i>Monarda fistulosa</i>	Wild Bergamont	0.50
<i>Panicum virgatum</i>	Switch Grass	4.00
<i>Pycnanthemum virginianum</i>	Common Mountain Mint	0.25
<i>Sagittaria latifolia</i>	Common Arrowhead	0.50
<i>Scirpus fluviatilis</i>	River Bulrush	1.00
<i>Solidago rigida</i>	Stiff Goldenrod	2.00
<i>Sorghastrum nutans</i>	Indian Grass	15.00
<i>Spartina pectinata</i>	Prairie Cord Grass	5.00
<i>Thalictrum dasycarpum</i>	Purple Meadow Rue	0.50
<i>Tradescantia ohiensis</i>	Spiderwort	0.25
<i>Veronicastrum virginicum</i>	Culver's Root	0.50
<i>Zizia aurea</i>	Golden Alexanders	1.50
Total		519.50

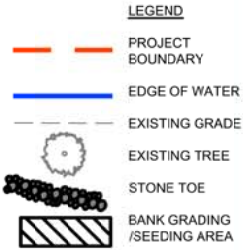
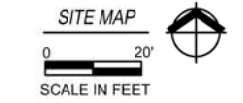
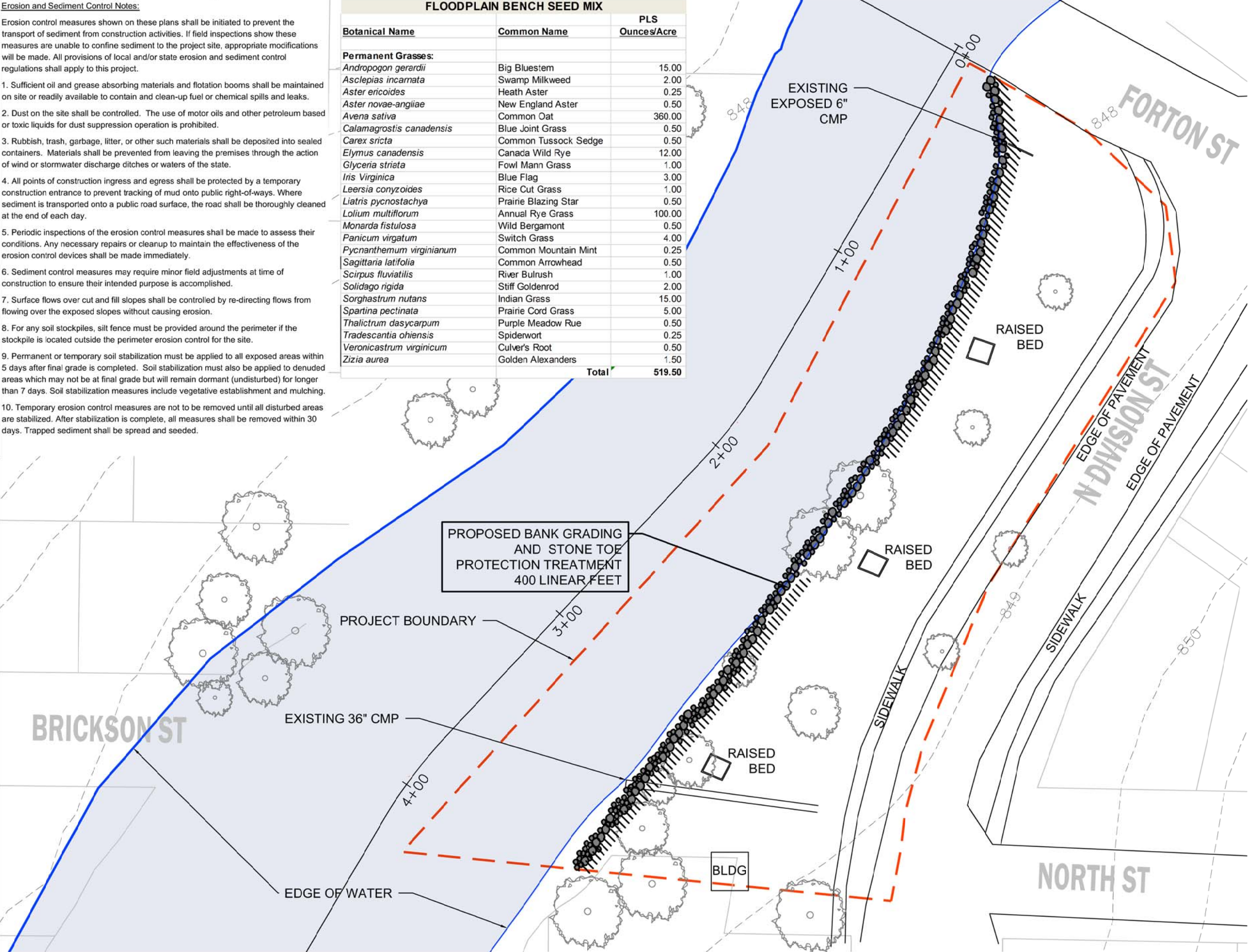

**MATERIALS:**  
SEED MIX  
0.05 ACRE  
EROSION CONTROL BLANKET  
200 SQUARE YARDS  
(1800 SQUARE FEET)

**Cardno**  
6140 COTTONWOOD DRIVE SUITE A  
FITCHBURG, WI 53562  
PH 608-661-2955 FAX 608-661-2961

REVISION	DATE	BY	APP

EROSION CONTROL / PLANTING PLAN  
YAHARA RIVER STREAM STABILIZATION PROJECT  
CITY OF STOUGHTON  
STOUGHTON, DANE COUNTY, WISCONSIN

DRAWN BY: COD  
DESIGNED BY: ACS  
DATE: FEBRUARY 2016  
JOB NO: 140201901

DRAFT

DRAWING NO.

5

OF 5









# Conservation Wish List

Photo: *Water Is His Everything* by Carissa Freeh

## What is your Conservation Wish List?

Does your water-related group have a wish list of projects, workdays or resource/materials that would help you with your conservation efforts or improve your organization's effectiveness? Put together a wish list and share it with the Dane County Office of Lakes and Watersheds!

## How will we use this information?

Our goal is to use this information to help connect you with groups and resources that can help accomplish some of your "wish list" items. Some examples of groups we could connect you to are listed below. Your "wish list" is not limited to the examples below. Please use this to help you start the brainstorming process:

💧 **UW Class Projects:** Many UW professors are looking for hands on projects so their students can gain real-life experience applying their classroom skills and knowledge.

*Ideas include, but are not limited to:* GIS mapping, computer modeling, translating resources into different languages, working on specific policy issues, marketing and social media strategies, fundraising campaign plans, website/logo design, community organizing, etc.

💧 **Scout-Ready Projects:** Scout troops and Eagle Scouts are always looking for projects that meet their criteria and are ready for action.

*Ideas include, but are not limited to:* Storm drain marking, trail building or maintenance, trail markers, stream stabilization, erosion prevention, native plantings, rain garden construction, kiosks, etc.

💧 **Workdays & Cleanups:** We occasionally get contacted by groups and organizations that are looking for volunteer opportunities. Your "wish list" will help us connect these groups to local project needs.

## Submitting your wish list:

Please fill out the "Conservation Wish List" form and return it to Susan Sandford at [sandford.susan@countyofdane.com](mailto:sandford.susan@countyofdane.com)





Dane County Watershed Network

# Conservation Wish List

Group Name:

Contact Person:

Email:

Phone number:

Description of project/activity/need:

Estimated number of volunteers required:

Estimate number of hours required:

Equipment/supplies provided:

Equipment/supplies needed:

---

Description of project/activity/need:

Estimated number of volunteers required:

Estimate number of hours required:

Equipment/supplies provided:

Equipment/supplies needed:

---

**\*\*\*\*\* Please copy and paste above fields for additional "Wish List" items \*\*\*\*\***

***Please return your Wish List to:***

Susan Sandford • 5201 Fen Oak Dr. Rm 234, Madison WI 53718 • (608) 224-3617 • sandford.susan@countyofdane.com